

# WIRELESS CHARGER

Office   
Home



Get rid of messy cables cluttering your work surface. Try the Power Logic Wireless Mobile Phone Charger.



## DIMENSIONS:

Height: 80.5mm (Approx. 3.17 in.)  
Max Width:  $\varnothing$  128.5mm (Approx. 5.06 in.)  
Cut-out:  $\varnothing$  95mm (Approx. 3.74 in.)

## ELECTRICAL

Input: AC 100-240 ~ 50/60Hz 0,38A Max.  
TX Module: Output DC/1A @ 5V

## MAINTENANCE AND CARE:

- Ensure unit is disconnected prior to cleaning.
- Clean the unit with a damp cloth and dry immediately.
- Do not use harsh chemical solvents.

## CHARGING INDICATOR

The unit features a blue LED ring that illuminates when a mobile device is placed correctly on the charging surface and is charging.

## CERTIFIED

The Wireless Charger is Qi certified and adheres to FCC and CE standards.

## AESTHETICS

The collar is made from high quality Aluminium while the charging pad is made from a durable, high gloss plastic. The Wireless Charger is available in both black and white.

## ULTRA SLIM

Almost flush with the desk surface, this product uses minimal space and does so efficiently.

## LOCKING RING

Secures the unit firmly in position, yet allows for easy removal for retrofitting or relocation.

## LARGE SCREW THREAD

The desk collar has been engineered for strength with an easy-to-screw thread which aids in quick and easy installation.

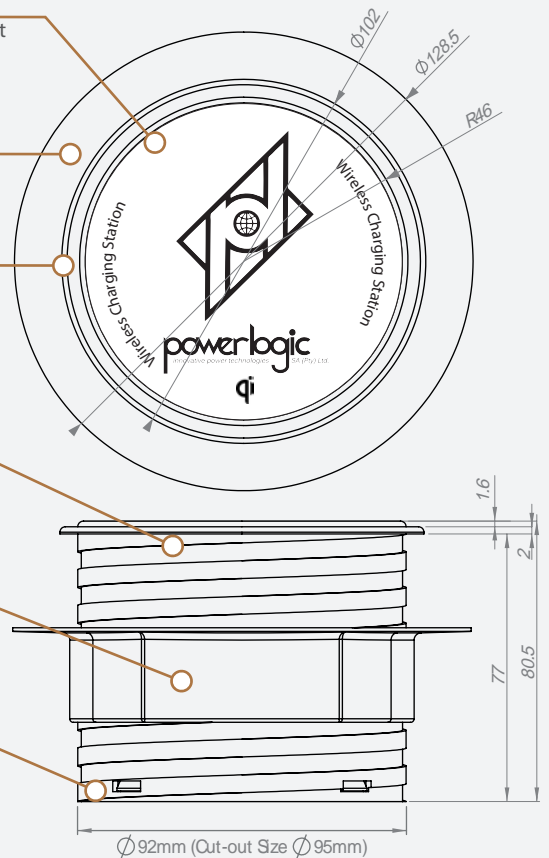

## INSTALLATION

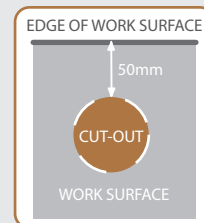

**STEP 1**  
Make a cut-out in a predetermined location with a diameter of 95mm (3 5/8 in.). Ensure there is sufficient clearance; 150mm below the work surface and at least 50mm between the cut-out edge and the edge of the work surface. Ensure the USB cable can reach the power point with ease.

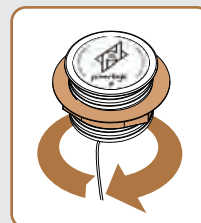

**STEP 2**  
Remove the locking collar by twisting it off in a clockwise direction (when viewed from above). Do not connect the unit to power until after the installation has been completed.

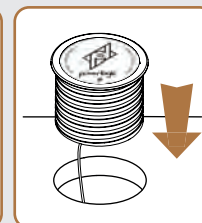

**STEP 3**  
Drop the unit, cable first, into the pre-cut mounting hole and angle the unit in the preferred orientation.

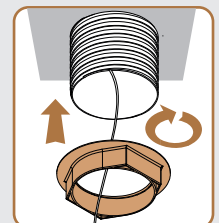

**STEP 4**  
Once the unit is positioned in the mounting hole, proceed to attach the locking ring by twisting it on in a clockwise direction (when viewed from below) until tightly fastened. Be sure to keep the unit in the desired orientation while fastening.

## PLEASE NOTE:

All products carry a 12 month limited warranty which excludes normal wear and tear and product abuse. In the event of product tampering, the warranty will be void.

## WARNING

- Avoid extreme outdoor temperatures and keep away from liquids. If any malfunction occurs, do not attempt to repair.
- Return product to manufacturer for repair.
- Do not insert foreign objects into data connectors.
- Freestanding on even surfaces or for in-counter top mounting.
- For other options, contact your distributor.

All measurements are in millimeters unless otherwise indicated

© 2017 Copyright Power Logic SA (Pty) Ltd. All Rights Reserved. Due to continual product improvements and upgrades, Power Logic reserves the right to amend and change products as it sees fit. As such, images of products are for indicative purposes only and actual products may vary from those depicted and certain options may be unavailable. Always check with your distributor or with Power Logic regarding availability of the product of your choice.